

# ARPOL MULTI-FIX

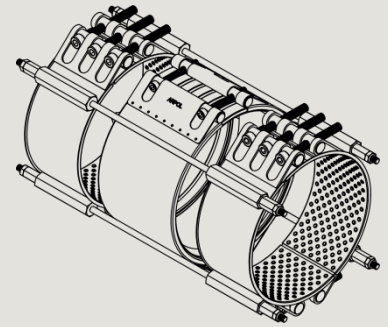

## Flexible Coupling with Pipe Restraint

### Submittal Information

Flexible pipe coupling for restraint connection of HDPE pipe systems with plain-ended pipes.

#### Materials

Casing	304L Stainless Steel or 316L Stainless Steel
Bars	304L Stainless Steel or 316L Stainless Steel
Bolts	304 Stainless Steel or 316 Stainless Steel Metric socket head cap screw, Stainless Steel bolts coated to prevent galling.
Anchoring band	304L Stainless Steel or 316L Stainless Steel
Restraining rod	304L Stainless Steel or 316L Stainless Steel
Welds	GMAW and GTAW welds. All welds fully passivated for enhanced corrosion resistance.

**Sizes and Working pressure** [See catalog](#)

**Standards** Complies with AWWA C227 Bolted Split Sleeve Couplings for Plain End Pipe

**Remarks** Pipe insert required  
The Arpol MULTI-FIX is the anchoring set only. The sealing coupling in the middle can be Arpol INSTAL or Arpol REP.



UNIONES ARPOL S.A. | [www.arpol.com](http://www.arpol.com) | [arpol@arpol.com](mailto:arpol@arpol.com) | Tel. +34 93 828 45 05 |  
Pol. Ind. Can Prat, Nave 1 (El Tortuguero) | 08691 Monistrol de Montserrat |  
Barcelona – SPAIN