

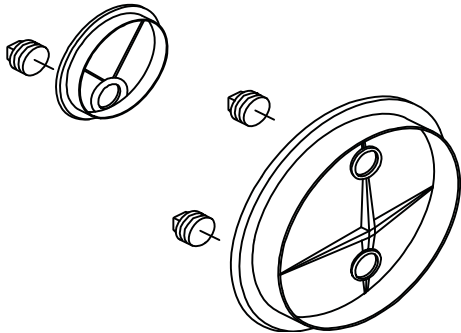

# 1410 & 1510 COUPLING END CAPS

## PRICE INFORMATION



### Standard Sizes:

4" to 12" Nominal Pipe OD

### USE:

Robar 1410 & 1510 End Caps are used in conjunction with a standard ROBAR coupling (ordered separately) for the purpose of: Temporary stops for mains to be extended in the future

### MATERIAL SPECIFICATION

CAP: Cast Ductile Iron (ASTM A536)  
 PLUG: Cast Iron - 2"IP square head  
 COATING: 1410 - two coats of Enamel  
 1510 - Corrosion Protective Epoxy Coated (AWWA C-213). NSF 61 Approved

For an enamel coated 8" End Cap, the ordering code is:  
1410 - 8"

Nominal Pipe Size	Cap OD	Outlet Plug Quantity	LIST PRICE	
			1410	1510
4	5.1	1	\$ 68.72	\$ 85.27
6	7.1	1	\$ 76.95	\$ 94.36
8	9.3	1	\$ 103.03	\$ 124.45
10	11.4	2	\$ 154.25	\$ 185.91
12	13.6	2	\$ 198.22	\$ 236.47

Note: End capped coupling must be restrained to resist hydraulic end thrust

### ROBAR INDUSTRIES LTD.

BC Phone (604) 591-8811 / 1-800-663-6553  
 Fax (604) 591-5288  
 Email: waterworks@robarindustries.com

### LES PRODUITS INDUSTRIELS ROBAR INC.

QUEBEC Phone (450) 441-7525 / 1-800-315-9525  
 Fax (450) 441-4894  
 Web: www.Robarindustries.com