

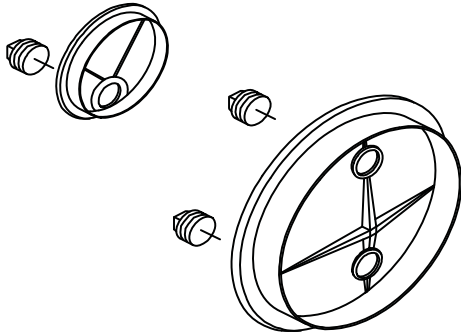

1410 & 1510 COUPLING END CAPS

PRICE INFORMATION



Standard Sizes:

4" to 10" Nominal Pipe OD

USE:

Robar 1410 & 1510 End Caps are used in conjunction with a standard ROBAR coupling (ordered separately) for the purpose of: Temporary stops for mains to be extended in the future

MATERIAL SPECIFICATION

- CAP: Cast Ductile Iron (ASTM A536)
- PLUG: Cast Iron - 2"IP square head
- COATING: 1410 - two coats of Enamel
1510 - Corrosion Protective Epoxy Coated (AWWA C-213).

For an enamel coated 8" End Cap, the ordering code is:
1410 - 8"

| Nominal Pipe Size | Cap OD | Outlet Plug Quantity | LIST PRICE | |
|-------------------|--------|----------------------|------------|-----------|
| | | | 1410 | 1510 |
| 4 | 5.1 | 1 | \$ 72.16 | \$ 89.53 |
| 6 | 7.1 | 1 | \$ 80.80 | \$ 99.08 |
| 8 | 9.3 | 1 | \$ 108.18 | \$ 130.67 |
| 10 | 11.4 | 2 | \$ 161.96 | \$ 195.21 |

Note: End capped coupling must be restrained to resist hydraulic end thrust

ROBAR INDUSTRIES LTD.

BC Phone (604) 591-8811 / 1-800-663-6553
 Fax (604) 591-5288
 Email: waterworks@robarindustries.com

LES PRODUITS INDUSTRIELS ROBAR INC.

QUEBEC Phone (450) 441-7525 / 1-800-315-9525
 Fax (450) 441-4894
 Web: www.Robarindustries.com